

1 3/4" SNAP LOCK

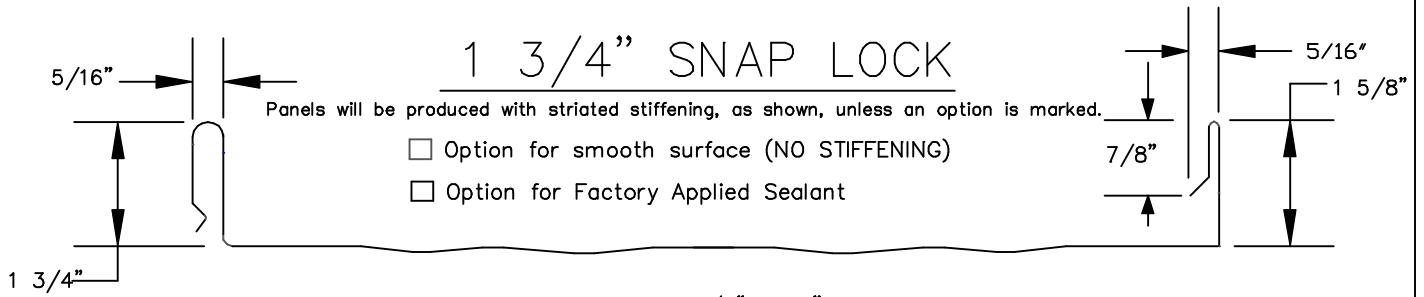

MODEL SL17518 1-3/4" X 18" SNAP LOCK

ADVANTAGES :

- POSITIVE SEAM ENGAGEMENT
- CONTINUOUS INTERLOCKING SEAM
- SINGLE EDGE SEAM
- EXCEEDS 200 lb> SEAM PULL-OFF TEST
- PREVENTS MOISTURE SEEPAGE
- ALLOWS FOR FREEZE-THAW EXPANSION & CONTRACTION

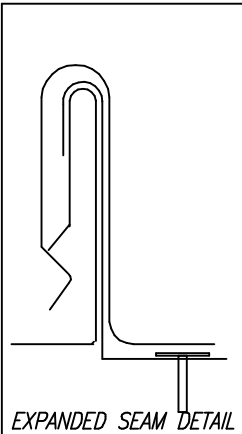

STANDARD PRODUCT OFFERING SEAM - ON CENTERS

12"

18"*

*Custom seam on centers available upon request. Consult METAL WORX for more information.

AVAILABLE BASE SHEET MATERIALS

- 26 Ga. - 22 Ga. HOT DIPPED GALVANIZED G-90
- 26 Ga. - 22 Ga. GALVALUME
- .032 & .040 ALUMINUM
- 20 oz. COLD ROLLED COPPER

PERFORMANCE STANDARDS

- UL 580 Class-90 Wind Uplift Rated
- ASTM E 1646 Water Penetration
- ASTM E 331 Water Penetration
- ASTM E 1680 Air Infiltration

AVAILABLE FINISH SYSTEM

KYNAR 500 - FLUOROPOLYMER FINISHES ARE STANDARD ON ALL PREFINISHED PRODUCTS.

KYNAR 500® is a registered trademark of Atochem of North America, Inc.
GALVALUM® is a registered trademark of Bethlehem Steel.



metal worx



Systems Inc.

SL17518 Panel